

HUMBER STREET GALLERY

EXHIBITION GUIDE

LEO FITZMAURICE

ENJOY CIVIC LIFE

19 MAY – 05 SEPTEMBER 2021

INTRODUCTION

In *Enjoy Civic Life*, Fitzmaurice presents a new body of work which responds to a collection within Hull's Guildhall, where hundreds of plaques are mounted to commemorate each ship visiting Hull's port from a new destination.

These hand-finished plaques, produced by Hull-based company GK Beulah & Co Ltd since 1939, have been used as a starting point to examine our reading of images and objects, in particular those associated with different types of transport and branding which surround us daily.

Through processes of physically editing, repeating, mirroring and manipulating scale, the artist successfully unmoors the meaning of things that are most familiar to us and transforms our relationship to them, and their relationship to one another. Fitzmaurice highlights how these image-word-objects have lives alongside ours, developing and adapting, like we do, to the changing world around us.

The interior architecture of Space 2 itself is transformed into a monochrome three-dimensional logo or icon, painted directly on the walls to create the sense of a series of large-scale boxes. This simple change highlights the idiosyncrasies of the space, left over from the building's days as a banana ripening warehouse. Often trying to remain hidden or seen as a distraction in a traditional white cube gallery setting, these unique traits are re-presented here as boxes or packaging to be looked at and considered alongside Fitzmaurice's smaller, intimate works.

Fitzmaurice has collaborated with artisans employed at Hull based company GK Beulah & Co Ltd and signage manufacturers at John E Wright & Co Ltd to produce selected works in the exhibition.

Fitzmaurice also presents his sculpture, *WayPoint*, 2020 in the Gallery Café.

Fitzmaurice has obtained the Pay Point Company's distinctive terminals for topping up credit, which have been assembled into a freestanding sculptural work. Referencing modernist and constructivist art, the artist cuts up several of these yellow and black terminals to emphasise their shield-like qualities to create an ironic totem to the circulation of cash.

ABOUT THE ARTIST

Leo Fitzmaurice, b.1963 Newport, Shropshire, England, now lives and works in Liverpool – based at The Bluecoat Studios. His work is described as a process of unmooring the meaning of things that are most familiar to us. To do this, he uses processes such as physically editing, repeating and mirroring, on images and objects such as packaging, brochures and signage and at a varying range of scales, from the very small and delicate through to the architectural.

He has exhibited extensively nationally and internationally. In 2004 Fitzmaurice was invited by the British Council to take part in the Artist Links residency at Vitamin Creative Space, Guangzhou, China. Since then he has shown work at MOT International; Seventeen Gallery; Tanya Leighton Gallery, Berlin; and Dodge NY. Solo projects have been hosted by Rogoland Kunstsenter, Norway; Grundy Gallery, Blackpool; New Art Gallery Walsall; Firstsite, Colchester. In 2012 Fitzmaurice was the recipient of the 5th Northern Art Prize. His work has been reviewed in *Frieze*, *Art Monthly*, *Blueprint*, *Hotshoe Magazine*, *Sculpture*, *Form and Eye* magazine. Fitzmaurice's work in the Arts Council Collection of England, Yorkshire Sculpture Park, Manchester Art Gallery, The Royal London Hospital, The Locus Plus Archive and numerous private collections.

WORK DETAILS, FLOOR 2

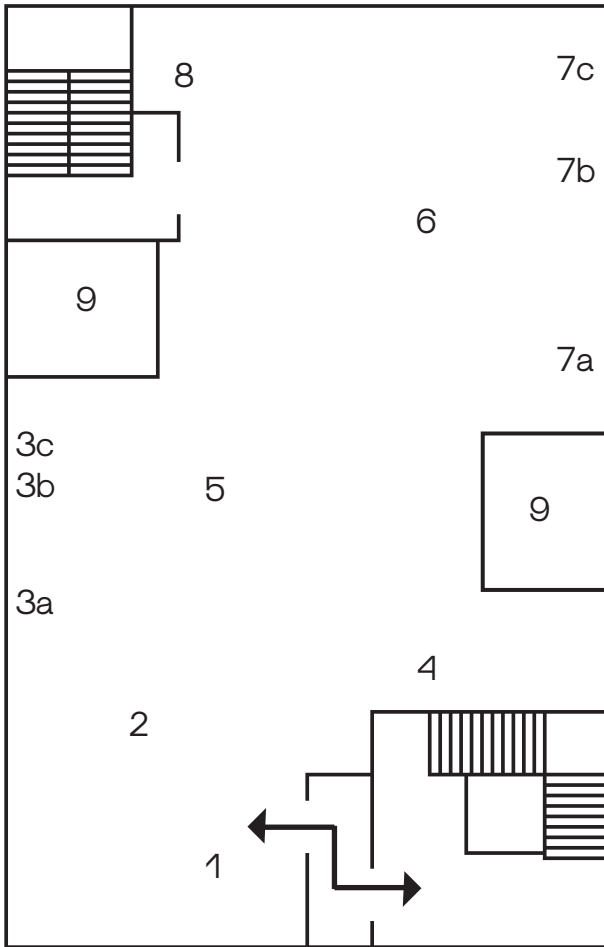

ENJOY CIVIC LIFE: SPACE 2

1. Hoard, 2020
Found and arranged packaging
30 x 50 x 40cm
2. Subway, 2020
Video, 34 sec, audio 30.22 mins looped
3. Blazons
 - 3a. Ferref, 2020
Hand painted 3D cast plastic
7 x 9 x 0.7cm
 - 3b. Notton, 2020
Hand painted 3D cast plastic
7 x 9 x 0.7cm
 - 3c. Toeeott, 2020
Hand painted 3D cast plastic
7 x 9 x 0.7cm
4. CC-CP, 2020
Manipulated Co-Op Sign
60 x 60 x 10cm
5. S6eq, 2020
Found plastic bags, chains,
metal poles
Various dimensions
6. B[]x w[]orks, 2020
Found manipulated packaging
Various packet sizes
7. Intersignia
 - 7a. Flair, 2020
Custom made vector file
based on found sign. Black
plastic, brushed aluminium,
red plastic
150 x 87 x 4cm
 - 7b. Allegro, 2020
Custom made vector file
based on found sign. Black
plastic, brushed aluminium
150 x 83 x 4cm
 - 7c. Galaxy 2020, Custom made
vector file based on found
sign. Black plastic, brushed
aluminium
170 x 68.5 x 4cm
8. Ba-Ba-Ba, 2020
Manipulated Barber Shop Sign
75 x 20 x 30cm
9. Appearances, 2020
Grey matt vinyl paint and undercoat
on stud wall
Various dimensions

RELATED ONLINE EVENTS

Book onto our free online public programme to learn more about the artist and the exhibitions. You can book your ticket by following the links on the [exhibition page](#).

DIGITAL DISCUSSION FORUM: SEMIOTICS, SIGNS AND LANGUAGE

23 JUNE 2021, 18:00–19:30

ONLINE, ZOOM

FREE

Signs, symbols and their meaning play a key role in Leo Fitzmaurice's artistic practice. Join artist and writer Nick Thurston for this online discussion forum surrounding Semiotics, the study of signs and symbols and their use or interpretation.

ARTIST IN-CONVERSATION: LEO FITZMAURICE WITH PAUL CAREY-KENT

4 AUGUST 2021, 18:00 –19:00

LIVE, SPACE 2 / ONLINE

FREE

Join curator and writer Paul Carey Kent and Artist Leo Fitzmaurice as they discuss the artist's latest body of work for Humber Street Gallery, *Enjoy Civic Life*.

ABOUT US

Humber Street Gallery is an Absolutely Cultured project. Originally established in 2017 as part of the City of Culture programme, it has developed into a vibrant, high-quality contemporary visual art space for Hull. It is now a significant contributor to the contemporary visual arts offer in the north.

Our ambition for Humber Street Gallery is to further develop the venue into a multi-artform and multi-functional creative centre, showcasing a wide range of art and activities providing something for everyone from visual art, dance, music to spoken word. Increasingly the space will be used to showcase more work by local as well as national and international practitioners.

OPENING TIMES

GALLERY

WED – SUN: 10:00 – 17:00

GALLERY CAFÉ

Wed – Sun: 10:00 – LATE

CONTACT US

Humber Street Gallery
64 Humber Street
Hull
HU1 1TU

absolutelycultured.co.uk/humberstreetgallery
info@absolutelycultured.co.uk
01482 323 484

Get the latest updates by following Humber Street Gallery on our official social media channels.

INSTAGRAM [@humberstreetgallery](https://www.instagram.com/humberstreetgallery)
FACEBOOK [@humberstreetgallery](https://www.facebook.com/humberstreetgallery)
TWITTER [@humberstgallery](https://twitter.com/humberstgallery)

Absolutely Cultured is a registered charity. If you would like to support our work, you can do so at absolutelycultured.co.uk

Official Funding Partners

